

ITEM # LIDIKIT20

20V Lithium Ion Digital Inflator

Instructions



READ ALL INSTRUCTIONS AND WARNINGS BEFORE USING THIS PRODUCT.

This manual provides important information on proper operation & maintenance. Every effort has been made to ensure the accuracy of this manual. These instructions are not meant to cover every possible condition and situation that may occur. We reserve the right to change this product at any time without prior notice.

**IF THERE IS ANY QUESTION ABOUT A CONDITION BEING SAFE OR UNSAFE,
DO NOT USE THIS PRODUCT!**

QUESTIONS? CONTACT CUSTOMER SERVICE.

Call Customer Service at 1-636-532-9888, Monday-Friday, 8 AM - 4 PM Central Time. A copy of the sales receipt is required.

KEEP MANUAL, SALES RECEIPT & WARRANTY FOR FUTURE REFERENCE



To register your product warranty, please visit buffalotools.com or scan the QR code.

PRODUCT SPECIFICATIONS

- Features High Pressure Inflation for auto, bike and more
- Features High Volume Inflate/Deflate for camping and household inflatable products
- Features LED Light and 12V Car Adapter
- Max Pressure: 160 PSI/11/Bar/1100kpa
- Flow Rate: 0.424 CFM
- Inflator Hose Length: 31"
- Includes: 1 x Inflator Needle Valve, 1 x Inflatable Mattress Adapter, 1 x Presta Valve Adapter
- Storage Compartment for accessories
- Digital display
- Charger Voltage: 100-240V/50-60Hz
- Rated Voltage: 20V (Lithium-ion battery)

PRODUCT COMPONENTS

- 1 LED Light On/Off
- 2 Inflate / Deflate Mode
- 3 Digital Display
- 4 Pressure Setting Increase/Decrease
- 5 Pressure Reset Button
- 6 Handle
- 7 High-volume hose
- 8 Tapered nozzle (high volume hose)
- 9 Universal valve adapter
- 10 High-pressure hose
- 11 High-volume pump deflate connection
- 12 High volume pump inflator connection
- 13 12V AC vehicle adapter
- 14 Inflator needle valve
- 15 Presta Valve Adapter
- 16 Standard tapered nozzle

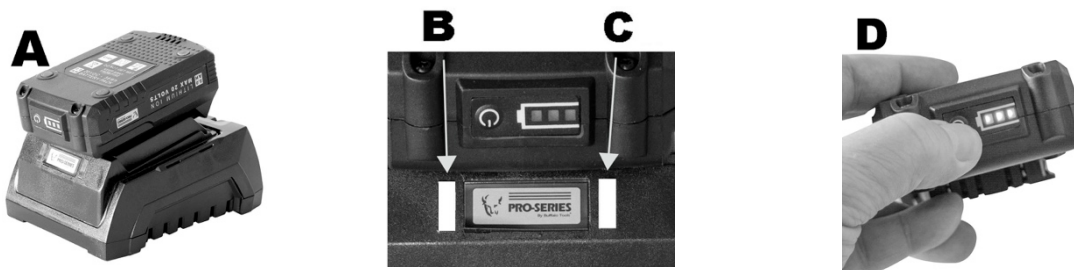
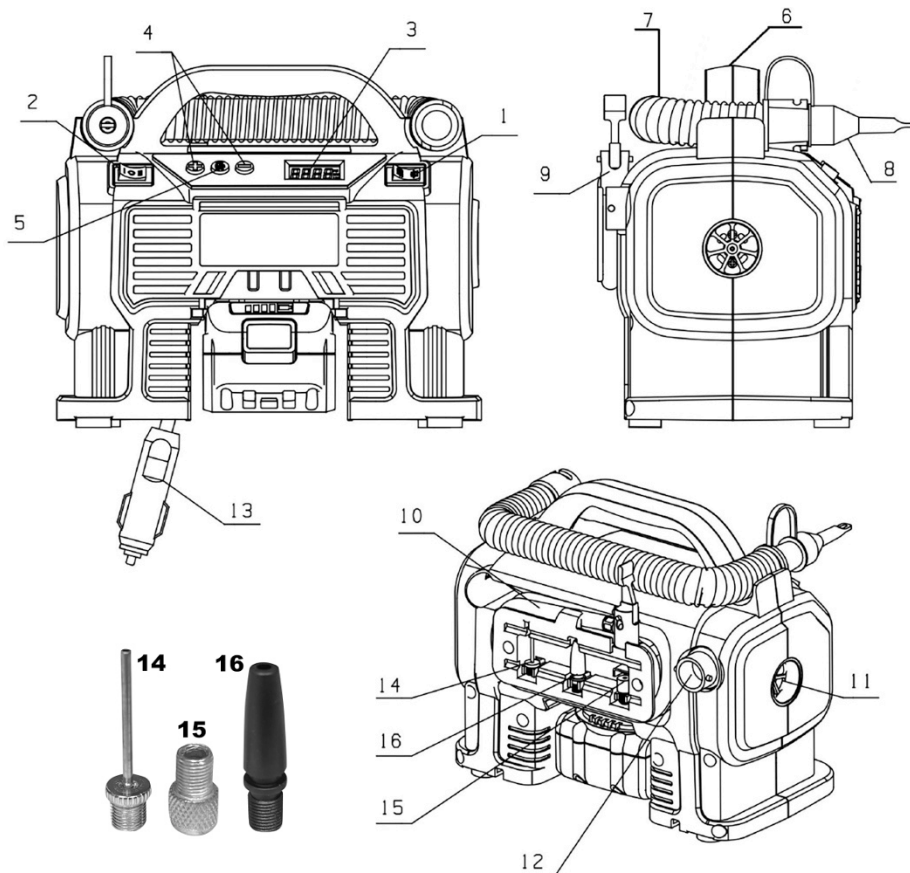

Charging The Battery

NOTE: For maximum performance and life of the lithium-ion battery pack, fully charge the battery before first use.

1. Plug charger into electrical outlet. (The power indicator light (C) will turn Green.)
2. Insert battery into charger (A), making sure the battery is fully seated. The (charging) light (B) will blink red continuously, indicating that the charging process has started.
3. When the green indicator light (C) remains ON continuously, the battery pack is fully charged and may be removed and used, or left in the charger.

NOTE: Press and hold the battery charge indicator button (D) to determine how much power remains in the battery. There are three lights that will indicate charge level: Low, Medium, and Fully charged.

Important Charging Notes

1. Long life and performance can be obtained if the battery pack is charged when the air temperature is between 41° – 104 °F. DO NOT charge when the battery pack is below 41 °F or above 104 °F. This will prevent serious damage to the battery pack.
2. The charger and battery pack may become warm to the touch while charging. This is a normal condition, and does not indicate a problem. To facilitate the cooling of the battery pack after use, avoid placing the charger or battery pack in a warm environment such as in a metal shed or an uninsulated trailer.
3. If the battery pack does not charge properly:
 - A. Check to see if receptacle has power.
 - B. Move the charger and battery pack to a location where the surrounding air temperature is approximately 41° – 104 °F
4. The battery pack should be recharged when it fails to produce sufficient power on jobs which were easily done previously. Follow the charging procedure. You may also charge a partially used pack whenever you desire with no adverse effect on the battery pack.
5. Do not freeze or immerse the charger in water or any other liquid.
DO NOT use under wet conditions or in presence of flammable liquids or gases. DO NOT let children come into contact with the tool. Supervision is required when inexperienced operators use this tool.

Installing and Removing the Battery Pack

NOTE: Make sure battery pack is fully charged. To install the battery pack #20 into the inflator, align the battery pack with the rails inside inflator's battery port #21 and slide it into the port until the battery pack is firmly seated. To remove the battery pack from the tool, press the release button #22 and firmly pull the battery pack out of the tool handle. Insert it into the charger to recharge the battery.

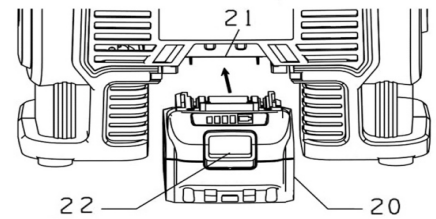

LED Light

Turn the toggle switch from Off to On. There are three LED lights on the side of the unit. You can carry the inflator by the handle and shine the LED light like a flashlight.

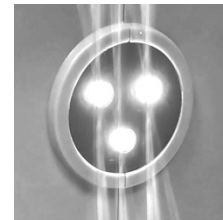

Power On

To wake up the system, the user will need to push the pressure mode / reset button #5. The digital readout will TURN ON and the inflator is ready for use. Before switching your inflator on, decide which power source to use: 12V AC adapter or 18V battery pack. To use the 12V AC adapter, or 18V battery pack, press the AC/DC power switch #1 located on the front of the unit to DC. If using the 12V AC vehicle adapter #13, always fully extend the 12V AC cord before each use. Connect the 12V AC vehicle adapter #13 into your vehicles' 12V AC accessory socket.

NOTE: When power is supplied to the inflator by 12V AC adapter (#13) or by 18V battery pack, the digital readout display will remain on for approximately 10 minutes before the display shuts off/goes into sleep mode. This occurs when the unit is not operating.

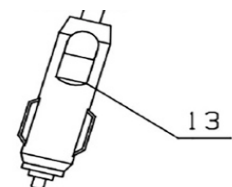

Fitting the Accessories for High Pressure Hose

The High Pressure Hose uses the Universal Valve Adapter (#9) which attaches to either the Inflator Needle Valve (#14), a Presta Valve Adapter (#15), or a standard Tapered Nozzle (#16). They are stored on the backside of the unit.

1. To use the Universal Valve Adapter (#9), make sure the lever (#17) is in the UP position, as shown.
2. Press the Inflator Needle Valve (#14), Presta Valve Adapter (#15), or Standard Tapered Nozzle (#16), into the valve adapter.
3. Press the lever (#17) on the universal valve adapter DOWN to lock it in place. Make sure the universal valve adapter is firmly locked in place before turning the inflator on

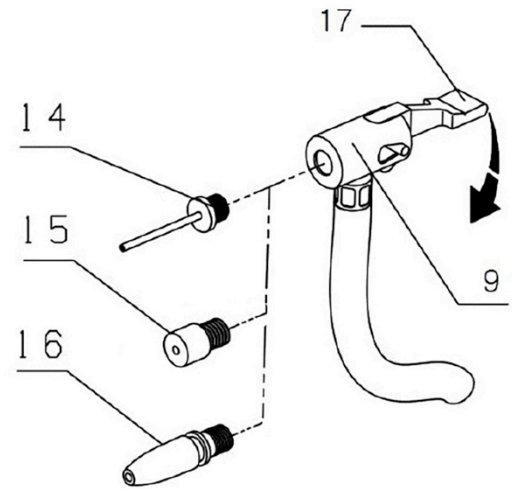

4. The Inflator Needle Valve (#14), the Presta Valve Adapter (#15), or the Tapered Nozzle (#16) are used for high-pressure inflatables like bicycle and automobile tires, sports balls, some air mattresses, etc.

NOTE: Always make sure that the lever is in the up position when not in use. Operate your inflator only with the universal valve adapter or with the included nozzles.

High-Volume Hose

The high-volume hose is meant to be used for objects that hold large amounts of air, such as some air mattresses, rafts, and swimming pool floats. (NOTE: The high-volume mode DOES NOT have an auto shut-off feature.)

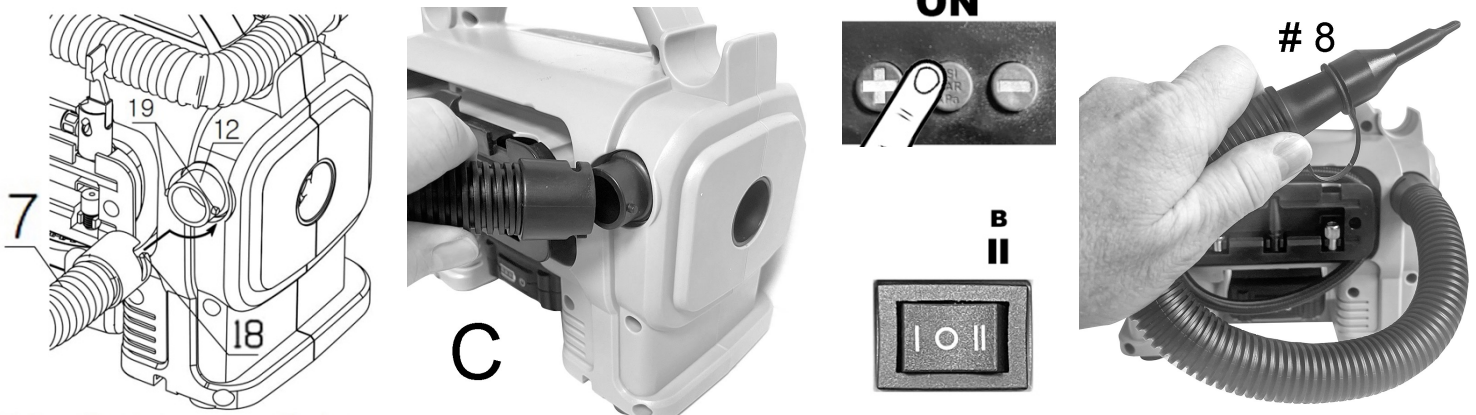

Inflation

1. Line up the notches #18 of the hose #7 with the nubs #19 of the high volume pump inflator connection #12. Then, slide the hose on and twist counter-clockwise to secure (C). (To remove, twist the hose clockwise and slide hose off. NOTE: Many inflatables have an internal flap that prevents air loss during inflation, especially air mattresses. Unless this flap is displaced by the nozzle, the inflatable will not inflate. Push the nozzle firmly into the valve to make sure that you push this flap out of the way.)
2. Press the ON button to power the unit, then press the Inflate button (B). Insert the tip #8 and begin inflation.

WARNING: Risk of Bursting! Excessive air pressure may cause a hazardous risk of bursting or personal injury. Check the manufacturer's maximum pressure rating for items being inflated.

NOTE: If the pressure rating for the item being inflated is above 100 p.s.i.g., the maximum run time is 10 minutes. Allow inflator to rest for 20 minutes before reusing.

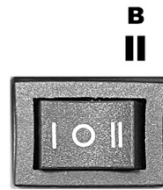
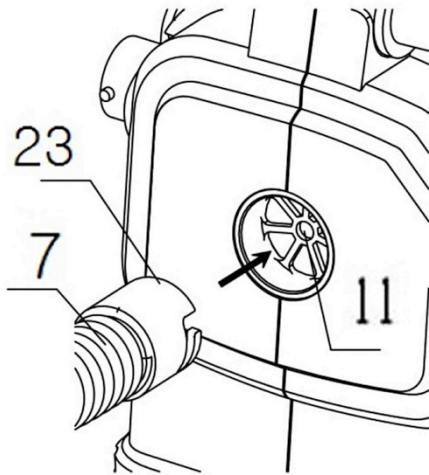

Deflation

1. Remove the high-volume hose #7 from the storage location.
2. Line up the hose end #23 with the high-volume pump deflate connection #11. Then, firmly slide in the hose so it is securely in place.
3. Press the ON button to power the unit, then press the Inflate button (B).
4. Insert the hose, or it's tapered nozzle #8 into the object being deflated.
5. When finished inflating, press the power button the O Off position. The display will remain on for up to 10 minutes.

WARNING: When deflating, large amounts of air will exit the high volume pump inflator connection #12. Ensure the universal valve adapter is not pointed at anyone or anything.

High Pressure Inflate For Auto/Truck/Bike

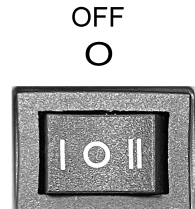
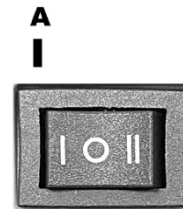
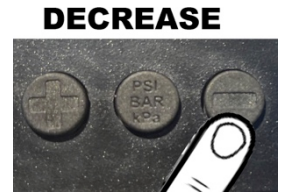
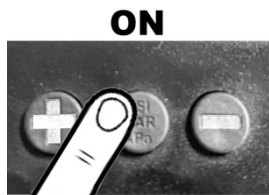

Use the High Pressure Inflator hose for objects that need more air pressure, such as tires and basketballs.

You can preset the digital pressure to a specific amount, and the inflator will shut off automatically when the preset pressure is attained. First, insert the needle valve into the Valve Adapter (VA). Press the power ON button. Then press the same button to toggle between PSI, BAR or KPA. Press the INCREASE or DECREASE buttons to add or subtract the amount of pressure required. The blinking numbers will display the target PSI. Press the Start button (A) to begin inflating the item. The inflator will automatically stop when the item reaches the preset PSI/ BAR/ KPA level. Then press the power button to the OFF position.

NOTE: You may notice the actual pressure reading may drop after a couple of seconds. This is normal.

To stop the inflator at any time, press the main power button back to the OFF position.

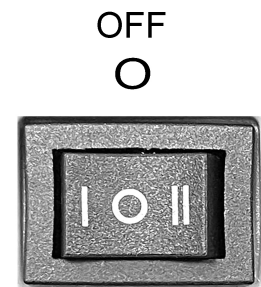

NOTE: If the power switch is turned off, all settings will be lost and will need to be reentered. This is a safety feature to prevent the risk of items over inflating.

Using the Inflator as a Pressure Gauge

1. Connect the universal Valve Adapter (VA) to the item to be checked.
2. Press the mode power switch ON.
3. The digital readout will display the item's pressure.

