

# MSMIXER

## Smoothie & Milk Shake Mixer

### Assembly & Operating Instructions



READ ALL INSTRUCTIONS AND WARNINGS BEFORE USING THIS PRODUCT.

SAVE THESE INSTRUCTIONS FOR FUTURE REFERENCE.

This manual provides important information on proper operation and maintenance. Every effort has been made to ensure the accuracy of this manual. We reserve the right to change this product at any time without prior notice.

**STOP!** DO NOT RETURN THIS PRODUCT TO THE RETAILER.

**Questions? Problems? CONTACT BUFFALO TOOLS.**

If you experience a problem or need parts for this product, visit our website <http://www.buffalotools.com> or call our customer help line at **1-888-287-6981, Monday-Friday, 8 AM - 4 PM Central Time**. A copy of the sales receipt is required.

## Smoothie & Milk Shake Mixer MSMIXER Assembly and Operating Instructions

COMMON SENSE AND CAUTION ARE FACTORS WHICH CANNOT BE BUILT INTO ANY PRODUCT. THESE FACTORS MUST BE SUPPLIED BY THE OPERATOR.

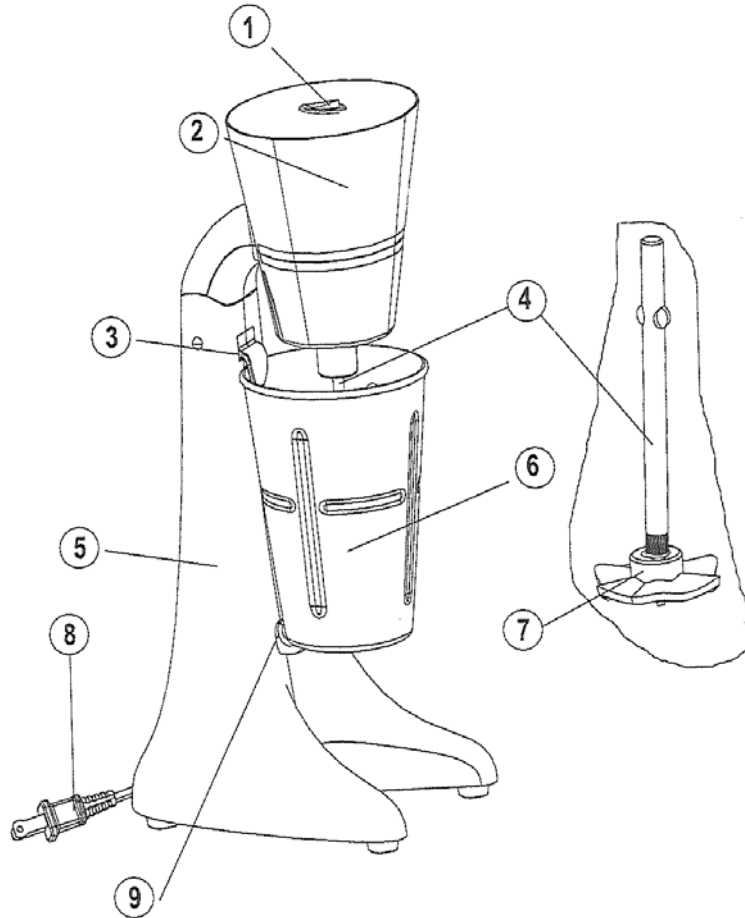

### Parts List

ITEM	DESCRIPTION	ITEM	DESCRIPTION
01	Hi/ Low Speed Switch	06	12 oz Aluminum Cup
02	Motor Housing	07	Mixing Blade
03	Switch Control	08	Cord
04	Mixing Wand	09	Cup Rest
05	Back Brace	10	12 oz Aluminum Cup

## Smoothie & Milk Shake Mixer MSMIXER Assembly and Operating Instructions

### Features

120 Volts / 60 Hz

12 oz. Aluminum Mixing Cup

2-Speed Motor

700-1050 RPM



### Operating Instructions

(Refer to diagram on page 2 of this manual)

1. Before operating, check that the power supply has adequate power to operate the Milk Shake Mixer. Check that the Main Power Switch (1) is in the OFF position. Plug the Power Cable (8) into a power supply.
2. Fill the Aluminum Cup (6) with your beverage, soft ice cream, or soft yogurt. Slip the Aluminum Cup into the lip of the Switch Control (3) and rest it on the Cup Rest (9). Turn the Main Power Switch (1) to the HI or LOW position. Allow the mixture to stir completely before turning Main Power Switch off. Remove aluminum cup. Unplug the Power Cable when Mixer is not in use.

### Precautions

**CAUTION: DO NOT RUN THE MOTOR EXCESSIVELY FOR MORE THAN 3 (THREE) MINUTES AT A TIME. THE MOTOR MAY OVERHEAT.**

**CAUTION: DO NOT INSERT YOUR FINGERS, HAND, SPATULA OR SPOON INTO THE ALUMINUM CUP WHILE THE MIXER IS TURNED ON. KEEP HANDS AND FINGERS CLEAR FROM MIXING WAND AND MIXING BLADE WHILE POWER IS TURNED ON.**

**CAUTION: WHEN TILTING THE MOTOR HOUSING FOR CLEANING, DO NOT ALLOW FINGERS TO BECOME “PINCHED” WITH THE HINGE ON BACK BRACE.**

**Remember to turn the Main Power Switch to the OFF position and disconnect the Power Cable from the power supply before cleaning, servicing, replacing the Mixing Blade. KEEP POWER CORD AWAY FROM LIQUIDS.**

**Wash hands after handling the power cord.** Touching the power cord could expose you to lead, which is known in the State of California to cause cancer, birth defects and other reproductive harm.

## **Product Use**

Plug Mixer into standard 120 Volt / 60 Hz grounded outlet. Fill the Aluminum Cup with proper amount of liquid so it does not overflow. Turn the Mixer on, and allow the Mixing Wand to stir the beverage. Choose the appropriate speed setting (HI or LOW) to mix the liquid.

NOTE: If adding Fruit or Ice to your beverage, make sure it is in small pieces. The Mixer will not be able to blend, break-up or chop large pieces. Do not add hard fruit or Cookie Dough.

NOTE: If adding Ice Cream or Yogurt, make sure it is soft and not hard. DO NOT USE HARD OR SOFT YOGURT.

## **Maintenance & Cleaning**

Warning: Always unplug the Power Cord from the electrical outlet before performing any maintenance or cleaning the Mixer.

Do not wash the motor housing in water.